

Raptor AW-45

Owners Manual

Specification:

- Newly redesigned tool for edging hard surfaces.
- Ergonomic design prevents users fatigue.
- Easy disassembly for field service.
- Swivel heads allows tool to "lay down" under fixtures.
- Top mount gun keeps hoses away from body parts.
- Brushed stainless steel wand-more durable than aluminum.
- Internal pressure hose.
- Rated up to 2500psi and 230°.



**TF TURBO
FORCE**
INTERNATIONAL

John 14:6

turbo-force.com

7905 N. 71st Ave. Glendale, AZ 85303

Limitation of Liability

Turbo Force International's (T.F.I.) liability on any claim for loss or damage connected with the supplying of goods, or their sale, resale, operation, or use, warranty, tort (including negligence) or other grounds, shall not exceed the price allowable to such goods or part thereof involved in any claim.

T.F.I shall not under any circumstances be liable for any labor charges, special or consequential damages including, but not limited to, bodily injury, loss of profits or revenues, loss of use of any product or associated product, cost of capital, cost of substitute products, facilities or services, downtime costs or costs of claims arising from Buyer or Buyer's customers.

Any technical advice or assistance furnished by Turbo Force International which concerns any goods supplied here under, will not subject T.F.I to any liability, whether based on contract, warranty tort (including negligence) or other grounds.

Warranty:

Turbo-Force International warrants that its product(s) (the Product) shall be free from defects in materials and workmanship under normal use, installation and maintenance in accordance with T.F.I. specifications for a period of 1 year from the date of purchase. If any failure to conform to this warranty is reported to T.F.I. within 1 year from the date of purchase by the original buyer, T.F.I., upon being satisfied of the existence of such non-conformity, will, with exclusions (wear and tear) etc., correct same at its discretion by repairing or replacing the Product.

Exclusions:

Interface ring or "boot" (R-B10) is covered from breakage or defect only for 90 days; there is no warranty against wear. Vacuum hoses, high pressure lines, and fittings are not covered under this warranty.

This warranty does not cover damage resulting from mishandling in transit, vandalism, misuse, abuse, neglect, alteration, dismantling, excess heat, acts of God or failure to exercise reasonable care in using or maintaining the Product. This warranty applies only to the original purchaser/owner of the Product. Original Sales receipt/sales contracts is required to validate warranty. To obtain service under this warranty, contact your dealer.

This warranty is in lieu of and excludes all other warranties, express or implied, arising by operation of law or otherwise, including any warranty or merchantability or fitness for particular purpose or otherwise, and no representation of warranty, expressed or implied, made by any sales representative or other agent of T.F.I. In no event shall T.F.I. be liable for incidental or consequential damages.

This warranty gives you specific legal rights which may vary from state to state.

Raptor AW-45

Owners Manual

Replacement Parts

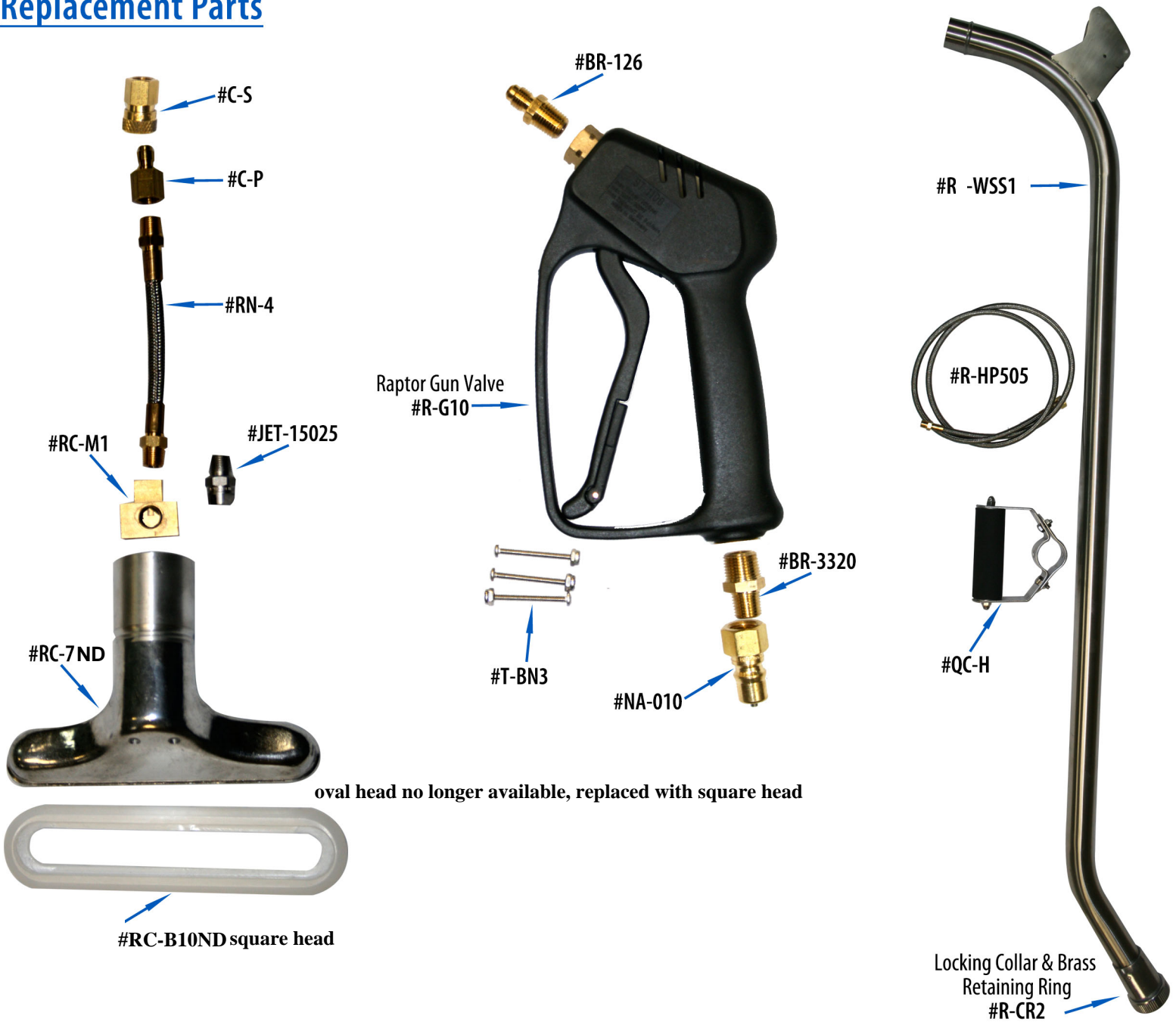

oval head no longer available, replaced with square head

#RC-B10ND square head

* It is important to note that when replacing the Classic head back in the locking collar, care should be taken to make sure the brass retaining ring seats properly in the groove of the head as you are tightening the collar cap. Move the head in and out slightly as you tighten the cap to insure a proper seat. Do not overtighten the cap as this will prevent the head from turning freely. Apply some marine grease or other water proof lubricant to the groove and neck before re-assembly to aid in the swivel action.

turbo-force.com

7905 N. 71st Ave. Glendale, AZ 85303

Raptor AW-45

Owners Manual

Replacement Parts

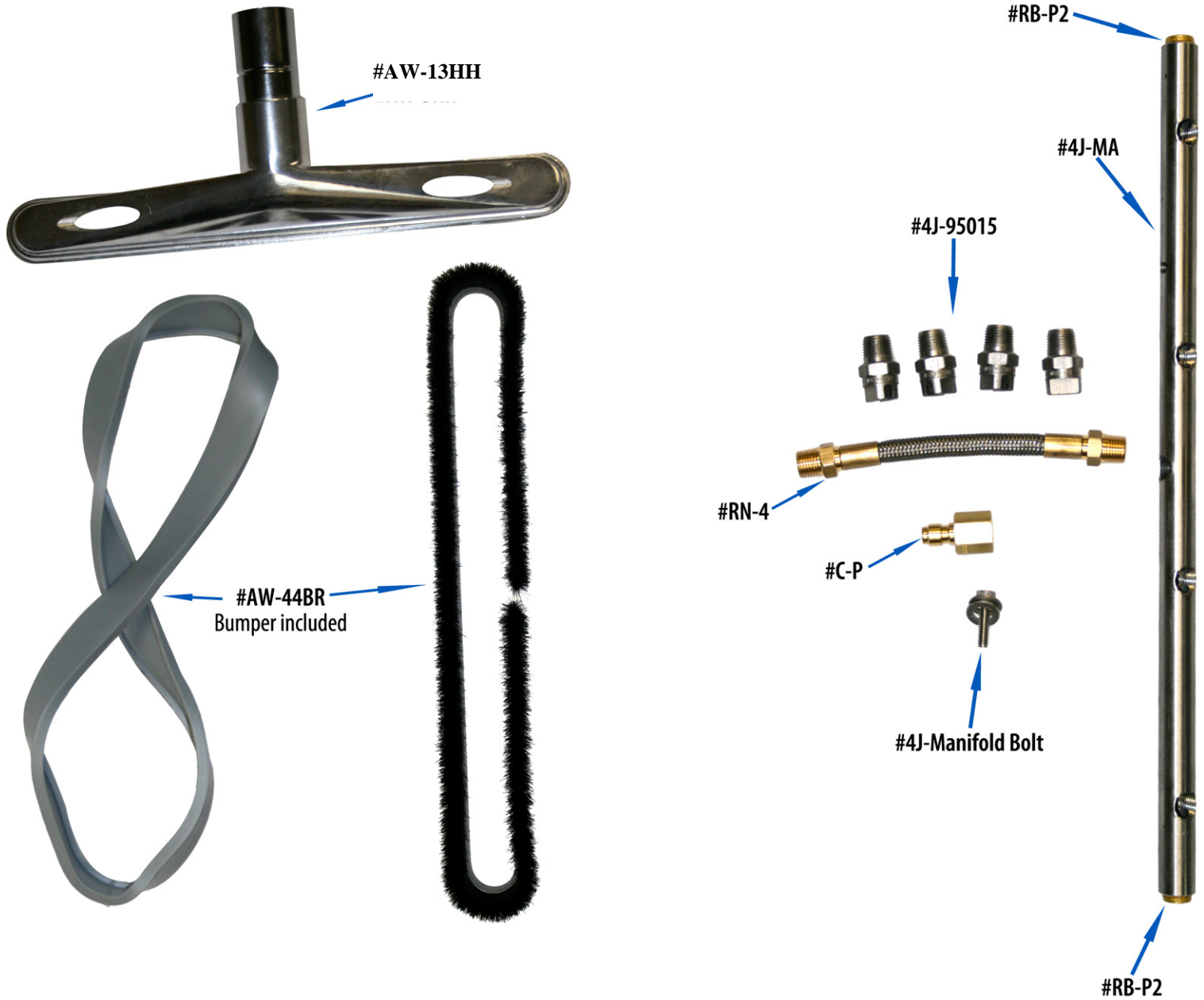

** It is important to note that when replacing the Classic head back in the locking collar, care should be taken to make sure the brass retaining ring seats properly in the groove of the head as you are tightening the collar cap. Move the head in and out slightly as you tighten the cap to insure a proper seat. Do not overtighten the cap as this will prevent the head from turning freely. Apply some marine grease or other water proof lubricant to the groove and neck before re-assembly to aid in the swivel action.*

turbo-force.com

7905 N. 71st Ave. Glendale, AZ 85303

Disassembly for Repair

For repair, replacement or cleaning of the Raptor assembly follow the following directions:

- 1.** To replace **High Pressure** hose, start by loosening and removing the swivel nut of the hose from the outlet of the classic gun. Unscrew the **Manifold Retaining Bolts** using a 1/8" allen wrench. This will allow you to pull the **Jet Manifold** block out of the **Classic Head**. You can now remove the hose from the manifold block using an 11mm brake line wrench (or 7/16"). Gripping the fitting is important as you may strip the fitting with a loose fitting tool. Replace hose using Teflon tape and reversing the above steps.
- 2.** To clean or repair the **Spray Jet(T-9)** Detach the **High Pressure Hose** and dismount the **Jet Manifold** as explained above. Place the **Jet Manifold** block in a vice and remove the **Jet** using a 5/16" or 8mm open-end wrench. Use Teflon tape after cleaning or replacing the **Jet**.
- 3.** Changing the **Classic Boot** requires a thin blade crew driver or flat blade inserted between the **Classic Head** and the boot near the rear of the head. Carefully pry the boot off the head. To install new boot insert the front edge of the Classic head into the leading edge of the boot pressing down slowly but firm while slowly bringing the rear downward until it snaps into groove.
- 4.** Restricted air flow may be caused by a hair ball or other obstruction within the Stainless Wand. Removing and re-inserting the **High Pressure Hose** will dislodge most obstructions.

NOTE: Be sure not to lose the brass locking ring under the locking collar.

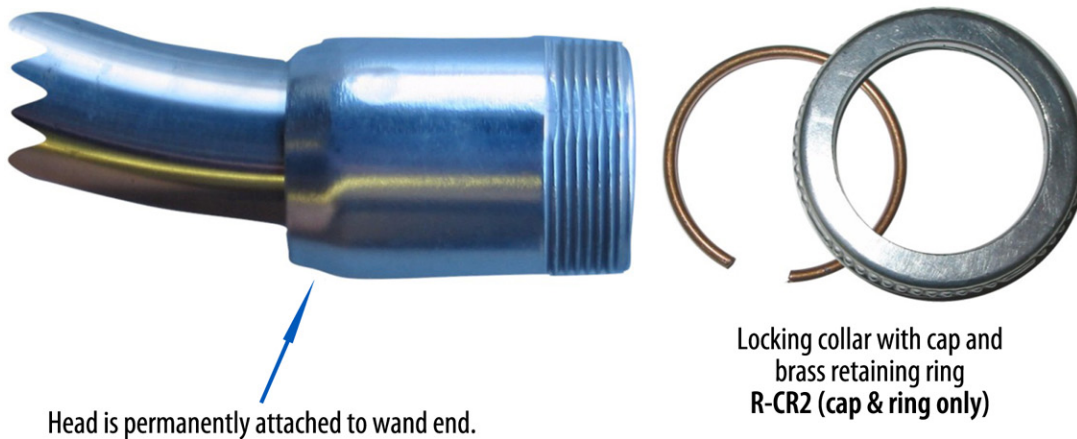

Cleaning Procedure For Ceramic Tile

1. Carefully move all furniture as over-spray can damage wood finishes and rust can leave a stain. Having a clear area to work in, makes a better job and minimizes tangled hoses.
2. Evaluate the floor or counter tops to clean, look for damage i.e. soft grout, cracks, holes and loose grout. Making recommendations for repairs first is better than trying to explain why later.
3. Pre-spray cleaning chemical in a small area to test first. Sometimes stronger stripping agents may be necessary if old waxes, or polymers need to be removed. For regular or restoration cleaning, apply pre-treatment to the tile area to be cleaned. Avoid getting pre-treatment chemical on carpet, dark wood, as the pH can cause problems that requires additional effort to remedy. Never pre-spray more than 30 to 50 square feet ahead of your extraction. Don't let pre-spray dry on the floor.
4. Make steady controlled passes guiding the Raptor QuickConnect head along the floor, overlapping as needed. Accuracy and speed will improve as you become efficient at using the Raptor QuickConnect.
5. When cleaning next to a carpet or wood floor, avoid lifting the Raptor QuickConnect to prevent water from over spraying.
6. Avoid walking on pre-sprayed area as this will track the material onto other areas. The chemical makes the floor extremely slippery.
7. Extract up as much water and pre-spray along with dirt as possible, and towel dry any puddles and damp spots as you go. Using a towel and a carpet brush or rake, dry any small puddles that remain. Water left to dwell on grout can bring up efflorescence, white chalky residue that precipitates.

Care and Repair: See parts diagrams for replacement parts & order number

1. Keeping a clean supply going into your truck mount will minimize problems.
2. Turbo Force recommends adding an in-line filter to the Raptor QuickConnect to minimize the chance of clogged jets.
3. The glide boot of your Raptor QuickConnect is constructed of a very abrasion resistant plastic and should give long life. When excessive wear occurs, the boot should be replaced.

Features of the Raptor QuickConnect

Your Raptor QuickConnect has been designed to clean tight areas under and against corners edges where the Turbo Hybrid may not access. Understanding and using this high impact tool insures you get the most out of it. The swivel lock collar permits you to rotate the wand until it lays flat on the floor giving you access deep under appliances and other fixtures.

** It is up to the operator to decide what kind of flooring can be cleaned. Turbo Force Int'l. makes no warranty or claims as to the specific types of flooring that can be cleaned. Turbo Force Int'l shall not be held liable for any damage or injury claims resulting from the use, misuse or abuse of the cleaning tools. There is always a risk of flooring damage when using extreme pressure and heat. Experience and proper training are essential to avoid costly damage claims including scratching of softer stone or other surfaces.*